

# AEROMATIC

## PROPELLER MODELS F200, AND F200H PARTS CATALOG

The Propeller With A Brain

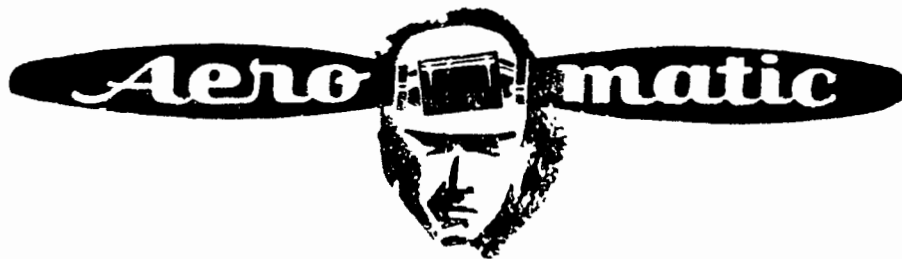

Propeller Division



**UNIVAIR AIRCRAFT CORPORATION**

ROUTE 3, BOX 59 AURORA, COLORADO 80010 →

Phone (303) 364-7661

*Univair*

# AEROMATIC PROPELLERS

MODELS F200 and F200H

## PARTS CATALOG

April 1, 1969

AEROMATIC PROPELLER DIVISION



**UNIVAIR AIRCRAFT CORPORATION**

ROUTE 3, BOX 59 AURORA, COLORADO: 80010 →

Phone (303) 364-7661

*Univair*

## INDEX

	Page No.
Manufacturer's Warranty Provision . . . . .	1
Current Installations - Models F200 and F200H . . . . .	2-3
Introduction . . . . .	4
How to use this Parts Catalog . . . . .	5
Instructions for Ordering Parts . . . . .	5
Numerical Parts List . . . . .	6-10
Numerical Parts List - Hi-Cruise Control . . . . .	11-13
Numerical Parts List - Blade Assemblies . . . . .	14
Numerical Parts List - "AN" Parts . . . . .	15-16
Service and Overhaul Tool List . . . . .	17
Service and Overhaul Tools Illustrated . . . . .	17A
Alphabetical Parts List . . . . .	18-23
Index Exploded View - Model F200 Hub Assembly . . . . .	24-25
Exploded View (Picture) - Model F200 Hub Assembly . . . . .	25A
Index Exploded View - Model F200H Hi-Cruise Control Assembly . . . . .	26
Exploded View (Picture) - Model F200H Hi-Cruise Control Assembly . . . . .	26A

M A N U F A C T U R E R ' S  
W A R R A N T Y   P R O V I S I O N

Manufacturer warrants all new propeller blades, and propeller assemblies and all parts manufactured by us to be free from defects in material and workmanship under normal use and service. Manufacturer's obligation is limited to the replacement or repair of any part or parts which, upon the examination made by the manufacturer or an authorized representative of the manufacturer, are found to be defective, and which are returned, with transportation charges prepaid, to the manufacturer within 90 days after such propeller has been installed by an authorized service station or distributor for the original purchaser or before such propeller has been flown 50 hours, whichever period is the shorter, but in no case longer than 6 months after manufacturing and assembly. We will not be responsible for any repairs made outside our factory without proper written authorization. With respect to parts not manufactured by the manufacturer but incorporated in the propellers or sold separately, manufacturer makes no warranty except that we will extend such warranties as the respective manufacturers of the parts permit.

While factory rebuilt propellers, accessories and parts are generally assumed to be equal to new, and our best effort is made to eliminate all potential defects, there is always the possibility that the useful life has been reduced due to previous service and/or repairs. No warranty, expressed, implied or statutory, shall apply to any such rebuilt propellers, accessories or parts.

This warranty is expressly in lieu of all other warranties, expressed, implied or created by law, and any other obligations or liabilities on the part of the manufacturer, and it neither assumes, nor authorizes any dealer or other person to assume for it, any other liability in connection with such propeller, parts, equipment and accessories.

UNIVAIR AIRCRAFT CORPORATION  
AEROMATIC PROPELLER DIVISION  
AURORA, COLORADO: 80010

# F-200 and F-200H AEROMATIC PROPELLERS



**"The Propeller With A Brain — Designed For Your Plane"**

## F.A.A. APPROVED INSTALLATIONS

<u>Airplane</u>	<u>HP</u>	<u>Hub Model</u>	<u>Propeller Assy. No.</u>	<u>Blade Model</u>
Aeronca 7AC, 11AC, S7AC, S11AC	65	F200	4324-1	00-72D or F
Aeronca 15AC	145	F200	4336-1	00-73E or F
Aeronca 15AC	145	F200	4389-1	00-74E
Bellanca 14-13	150	F200	4256-1	00-74A
Bellanca 14-13 with Hi-Cruise	150	F200H	4275H-1	00-74B or C
(1) Cessna 120, 140	85	F200	4312-1	00-73E or F
Cessna 120, 140	90	F200	4340-1	00-73E or F
Cessna 170A with Hi-Cruise	145	F200H	4356H-1	00-74E
Commonwealth 185	85	F200	4306-1	00-74C
Ercoupe 415C, CD	75	F200	4305-1	00-73E or F
Ercoupe E, G	85	F200	4305A-1	00-73E or F
Goodyear GA-2	145	F200	4280-1	00-78BL
Goodyear GA-2B	165	F200	4378-1	00-76BL
Jamieson J-1 with Hi-Cruise	115	F200H	4368H-1	00-74E
Meyers MAC-125C	125	F200	4290-1	00-74E
Monocoupe 90AF-100	100	F200	4283-1	00-74E
Piper J3-C	85	F200	4369-1	00-72D or F
Piper PA-11	90	F200	4348-1	00-73E or F
Piper PA-12, PA-12S	100	F200	4292-1	00-74E
Piper J5-C	104	F200	4330-1	00-74E
Piper PA-12, PA-14 with Hi-Cruise	115	F200H	4292AH-1	00-74E
(2) Piper PA-16	115	F200	4368-1	00-73E or F
(2) Piper PA-16 with Hi-Cruise	115	F200H	4292AH-1	00-74E
Piper PA-18, PA-19	90	F200	4348-1	00-73E
Piper PA-20 with Hi-Cruise	125	F200H	4394H-1	00-74E
Swift GC-1A	85	F200	4279-1	00-72D or F
Swift GC-1A	85	F200	4242-1	00-72C
Swift GC-1B	125	F200	4277-1	00-73E or F
Swift GC-1B	125	F200	4261-1	00-73D
Stinson 108, 108-1	150	F200	4243-1	00-76B
(3) Stinson 108, 108-1	150	F200	4296-1	00-76B
(4) Stinson 108-2, 108-3	165	F200	4320-1	00-76B
Temco TE-1A with Hi-Cruise	145	F200H	4384H-1	00-74E
Temco TE-1A with Hi-Cruise	165	F200H	4396H-1	00-74E

(1) Modification necessary to engine cowling 1948 models only. See Aeromatic drawing 3323 furnished with propellers.

(2) Requires Piper Aircraft part numbers 12833-00, 12826-00, 12832-00, 80002-09 and 7511-09. Order through Piper distributors or factory.

(3) 5" diameter bolt circle on mounting flange.

(4) Requires under cylinder cooling baffles furnished by Aeromatic, part no. 4086.

7-11  
**FOREIGN AIRCRAFT INSTALLATIONS**

# AEROMATIC PROPELLERS

## MODELS F200 and F200H

AIRPLANE	H.P.	HUB MODEL	PROPELLER ASS'Y NO.	BLADE MODEL
Aeronautica Macchi MB-308 (Italy)	90	F200	4392-1	00-73E
Aeronautica Macchi MB-320 (Italy)	185	220	4370	0-85
Auster Mark V (England)	125	F200	4277-1	00-73E
Desford Trainer (England)	136	F200	4376-1	00-76BL
Fokker F-25 (Holland)	190	220	4289	0-86AL
Fokker S-11 (Holland)	190	220	4339	0-85
Karhu 48 (Finland)	190	220	4272	0-82
L'Aronautique S-90 (France)	85	F200	4313-1	00-68E
Lark KZ-VII (Denmark)	125	F200	4307-1	00-74E
NORD 1200 (France)	125	F200	4318-1	00-73E
Piaggio Model P-136 (Italy)	215	220	4360	0-82LS
Pilatus P-4 (Switzerland)	190	220	4308	0-85
SAAB 91 (Sweden)	190	220	4294	0-82
Iberavia I-11 (Spain)	90	F200	4340-1	00-73E

# PARTS CATALOG

## AEROMATIC PROPELLER

### MODELS F200 AND F200H

#### 1. INTRODUCTION

This catalog is prepared to facilitate identification of any part used in the AEROMATIC Model F200 and F200H propeller. The method of using each section and what it contains is described below:

**NUMERICAL PARTS LIST**– This section lists parts used in the AEROMATIC Model F200 and F200H propellers. Part numbers are arranged in numerical order. Following the part is listed the correct name of the part and the quantity used in assembly of the propeller. The unit price of each part is listed.

**NUMERICAL STANDARD PARTS LISTED**– This section lists all AN standard parts which are used in the AEROMATIC Model F200 and F200H propellers.

**ILLUSTRATED PARTS LIST**– This section contains an exploded view and an assembly view of the AEROMATIC Propeller assembly used in the HI-CRUISE pitch change mechanism used on Model F200H propeller.

**SERVICE AND OVERHAUL TOOLS LIST** contains the tool number and correct name of tools needed in the service and overhaul of ALL AEROMATIC Model F200 propellers. Following the tool name is listed the net price of each tool.

**ALPHABETICAL PARTS LIST**– This section contains a listing of all parts used in the AEROMATIC Model F200 and F200H propellers and is arranged in alphabetical order by part name.

## **2. HOW TO USE THIS CATALOG**

When neither the name nor the number of the part is known, turn to the ILLUSTRATED PARTS LIST section. Locate the part number from the exploded view of the AEROMATIC propeller assembly. Find this number in the NUMERICAL PARTS LIST section and identify the part by name and number.

When only the name of the part is known, refer to the ALPHABETICAL PARTS LIST and obtain the part number. Turn next to the NUMERICAL PARTS LIST and by using this part number, the quantity used and the unit price can be obtained.

When only the part number is known, it is necessary to consult only the NUMERICAL PARTS LIST in order to obtain the part name, quantity used, and unit price.

Proper names and tool numbers of service and overhaul tools can be determined by referring to the SERVICE AND OVERHAUL TOOLS section. If it is necessary to further identify the tools, refer to the ILLUSTRATED PARTS LIST and locate the tool number from the tools shown.

## **3. INSTRUCTIONS FOR ORDERING PARTS**

When ordering parts state the part number, the correct part name, and the quantity desired. Always state the model and serial number of the propeller. Parts marked (S) can be purchased only by Authorized Service Stations. When (S) parts are ordered, the propeller assembly number and type of aircraft and engine on which the propeller is to be used must be given. Unless credit has been established with Univair Aircraft Corporation, Aeromatic Propeller Division, all parts will be shipped C.O.D. or with sight draft attached to bill of lading on freight shipment.

NUMERICAL PARTS LIST

AEROMATIC PROPELLER

MODELS F200 and F200H

<u>Part No.</u>	<u>Part Name</u>	<u>No. Req'd</u>	<u>Unit Price</u>
2170	Transfer- Trade Mark	2	.75
2185	Flange Seal Plate	2	1.75
2187-40B	Plastic Aeroloid ( 8 sq. ft. approx.) (S)	As Req'd	12.50
2191	Snap Ring - Flange Plate	2	.45
2195	Sleeve - Bearing Preload	1	3.00
2195B	Sleeve - Bearing Preload Cushion	1	6.30
2198	Lockpin - Preload	1	1.90
2199	Pilot - Bearing Preload	1	3.50
2290	Lead Wool -(Per lb.)	As Req'd	1.00
2428-25	Transfer-Check Lubricant (25 hrs.)	1	.10
2506	Washer - Attaching Bolt	8	.50
2667	Snap Ring - Thrust Brg. Ret.	2	3.75
2668	Bearing - Preload	2	4.75
2674-16	Shim - Low Pitch Adjustment	As Req'd	.60
2674-62	Shim - Low Pitch Adjustment	As Req'd	.80
2681	Pin - Synchronizer Piston	1	.80
2682	Piston - Synchronizer Piston	1	2.25
2704	Bearing - Thrust	2	23.50
2704-1	Bearing - Thrust (To fit No. 3288-1 Flange)	2	Order Special

# NUMERICAL PARTS LIST

## AEROMATIC PROPELLER

### MODELS F200 and F200H

Part No.	Part Name	No. Req'd	Unit Price
2704B	Bearing Balls	50	.10
2705	Seal - Thrust Bearing	2	.93
2706	Spring - Balancing Weight	As Req'd	.17
2711	Name Plate - Hub	1	.75
2712	Snap Ring - Cw't Arm	2	.18
2714-3	Washer - Cw't Arm Locating Screw	2	.08
2721-1	Counterweight (.25 oz.)	As Req'd	.35
2721-2	Counterweight (.5 oz.)	As Req'd	.40
2721-3	Counterweight (1.0 oz.)	As Req'd	.45
2721-4	Counterweight (2.0 oz.)	As Req'd	.50
2721-7	Counterweight (5.0 oz.)	As Req'd	1.50
2721-9	Counterweight (2.5 oz.)	As Req'd	.55
2740	Plug - Lubricant	1	.15
2810-21	Cork - Blade Shank Sealing	2	.06
2819	Seal - Synchronizer Cover Plate	1	.25
2832-8	Screw - Sync. Cover Plate (1/2")	6	.25
2832-10	Screw - Sync. Cover Plate (5/8")	6	.30
2832-12	Screw - Sync. Cover Plate (3/4")	6	.40
2876	Weight - Balancing	As Req'd	.15

# NUMERICAL PARTS LIST

## AEROMATIC PROPELLER

### MODELS F200 and F200H

<u>Part No.</u>	<u>Part Name</u>	<u>No. Req'd</u>	<u>Unit Price</u>
2879	Cover - Synchronizer Cylinder	1	.95
2894	Screw - C'wt Arm Locating (5/16-24)	2	.65
2910	Link - Synchronizer ( Left Hand)	2	17.75
2914	Seal - Flange Plate	2	.60
2918	Plate - Thrust Bearing Retainer	2	12.60
2951	Balancing Weight Band	2	4.90
2959	Button - Sync. Piston Pin	2	.40
2961	Pin - Name Plate Locking	4	.06
2967	Tipping - Leading Edge	2	3.50
2983-6	Rivet - Tipping	As Req'd	4.90/lb
2984-3	Screw - Tipping ( 3/8'' )	As Req'd	.05
2984-4	Screw - Tipping ( 1/2'' )	As Req'd	.05
2987-S	Tipping - Cap ( std. )	2	2.75
2993-5	Shim - Flange Seal Packing ( Inner)	As Req'd	.08
2993-16	Shim - Flange Seal Packing ( Inner)	2	.08
2995-1	Spring - Flange Seal Packing	2	.25
3239	Counterweight Arm	2	27.30
3276-1	Flange - Blade ( L.H. Tractor)	2	Order Special
3277-1	Flange - Blade	2	79.90

NUMERICAL PARTS LIST

AEROMATIC PROPELLER

MODELS F200 and F200H

<u>Part No.</u>	<u>Part Name</u>	<u>No. Req'd</u>	<u>Unit Price</u>
3288-A	Blade Flange (L.H. Pusher)	2	Order Special
3288-1	Blade Flange (L.H. Pusher)	2	Order Special
3298-5	Screw - C'wt Arm Locating	2	.70
4357	Tipping - Cap (Seaplane) - Not Available	2	
4766	Hub - only - (S)	1	99.50
4766H	Hub ( for Hi-Cruise ) - (S)	1	99.50
20003-1	Spacer - Low Pitch Stop ( .092" )	As Req'd	.50
20003-2	Spacer - Low Pitch Stop ( .125" )	As Req'd	.50
20011	Kit - Plastic Repair		3.30
20029	Instruction Booklet - With Complete Propeller		N.C.
20035	Label - Patent - With New Propeller	2	N.C.
20036	Shim - Flange Seal Packing (Outer)	2	.38

NUMERICAL PARTS LIST

AEROMATIC PROPELLER

MODELS F200 and F200H

<u>Part No.</u>	<u>Part Name</u>	<u>No. Req'd</u>	<u>Unit Price</u>
20096	Bushing - Cushion Preload	1	3.12
20101	Shim - Flange Seal Packing (Flared)	2	.40
20101	Lock - Bearing Retainer Snap Ring	2	.40
20105A	Lock - Bearing Retainer Snap Ring Oversize. Use only on hubs marked with a letter "G" stamped on the Synchronizer Cylinder flange face.	2	.40
20109	Packing - Flange Seal (Supersedes 2994)	2	1.10
20122	Manual - Service (Model F200)	1	2.50
20125	Transfer - Push To Increase RPM	1	N.C.
20145	Transfer - Snap Ring Opening	2	N.C.
20239-1	Lubricant - Aeromatic 5M (pint)		1.00
20239-8	Lubricant - Aeromatic 5M (Gal.)		6.00
20366	Link Synchronizer	2	6.30

# HI-CRUISE CONTROL PARTS LIST

## AEROMATIC PROPELLER MODEL F200H

<u>Part No.</u>	<u>Part Name</u>	<u>No. Req'd.</u>	<u>Unit Price</u>
3355	Regulator Valve Assy. (Std.)	1	80.00
3355-1	Regulator Valve Assy. (Piper)	1	80.00
20252	Piston Synchronizer	1	28.60
20259	Screw - Low Pitch Stop	1	2.75
20263	Seal - Engine Flange Continental & Franklin Engines without Spinner	1	.70
20265	Seal - Engine Flange Lycoming Engines and all engines with spinners.	1	.70
20268	Oil Line Assy. -Hub	1	6.50
20272	"O" Ring (1-1/16" O.D.)	1	.55
20274	"O" Ring (3" O.D.)	1	.90
20291-2	Cable - Control (Stinson)	1	26.70
20291-5	Cable - Control (Bellanca)	1	26.70
20291-8	Cable - Control (Piper)	1	25.70
20295	Adapter - Junction - Oil Line (Franklin engine)	1	20.00
20310	Plate - Synchronizer Piston	1	.75
20316	Stop - Climb Low Pitch	1	36.96
20340	Adapter - Junction - Oil Line (Lycoming engine)	1	26.80
20341	Gasket - Adapter - Junction (Continental engine)	1	.45

# HI - CRUISE CONTROL PARTS LIST

## AEROMATIC PROPELLER MODEL F200H

<u>Part No.</u>	<u>Part Name</u>	<u>No. Req'd.</u>	<u>Unit Price</u>
20342	Adapter - Junction - Oil Line ( Continental )	1	37.50
20343	Gasket - Adapter - Junction ( Franklin )	1	.40
20357	Gasket - Junction Adapter ( Lycoming )	1	.40
20360	Bracket - Regulator Valve Mounting ( Piper )	1	25.40
20378	Inverted 45° Elbow	As Req'd.	1.50
20383	Cylinder - Hi-Cruise Control	1	46.50
20384	Spring - Actuating Piston	1	1.50
20385	Piston - Actuating	1	25.81
20386	Cover - Actuating Cylinder	1	24.55
20399	Gasket - Actuating Cylinder Cover	1	.20
20406-8	Oil Line - Flexible	1	Prices on request
20406-13	Oil Line - Flexible	1	" " "
20406-14	Oil Line - Flexible	1	" " "
20407-10	Oil Line - Flexible	1	" " "
20407-12	Oil Line - Flexible	1	" " "
20408-8	Oil Line - Flexible	1	" " "

# HI - CRUISE CONTROL PARTS LIST

## AEROMATIC PROPELLER MODEL F200H

<u>Part No.</u>	<u>Part Name</u>	<u>No. Req'd.</u>	<u>Unit Price</u>
20408-10	Oil Line - Flexible	1	Prices on Request
20408-11	Oil Line - Flexible	1	" " "
20408-12	Oil Line - Flexible	1	" " "
20408-13	Oil Line - Flexible	1	" " "
AN486-1	Clevis - Control Cable End	1	1.75
AN3066-20	Nut - Lock - Hi-Cruise Stop	1	.40
AN960-8	Washer - Cover Screw	8	.05
2934-3	Washer - Copper - Cylinder Screw	6	.18

NUMERICAL PARTS LIST  
AEROMATIC PROPELLER MODELS F200 and F200H  
BLADE ASSEMBLIES

<u>Part No.</u>	<u>Part Name</u>	<u>Unit Price</u>
P4918-76	Blade Assembly - Model 00-76B	125.00
P4999-74	Blade Assembly - Model 00-74B	125.00
P40002-73	Blade Assembly - Model 00-73E	125.00
P40003-74	Blade Assembly - Model 00-74E	125.00

NUMERICAL PARTS LIST  
AEROMATIC PROPELLER MODELS F200 and F200H

A-N PARTS

<u>Part No.</u>	<u>Part Name</u>	<u>Unit Price</u>
AN3-21	Bolt - Balance Band	.10
AN3-22	Bolt - Balance Band	.10
AN4-11A	Bolt - Valve Mounting (Piper)	.10
AN6-14	Bolt - Counterweight (1-1/2")	.16
AN6-15	Bolt - Counterweight (1-5/8")	.17
AN6-16	Bolt - Counterweight (1-3/4")	.17
AN6-17	Bolt - Counterweight (1-7/8")	.18
AN6-20	Bolt - Counterweight (2")	.19
AN6-21	Bolt - Counterweight (2-1/8")	.20
AN6-22	Bolt - Counterweight (2-1/4")	.20
AN6-23	Bolt - Counterweight (2-3/8")	.20
AN7-20	Bolt - Counterweight Arm Clamp	.35
AN74A-11	Bolt - Junction Adapter (Piper)	.35
AN74A-25	Bolt - Bracket Regulator Valve (Lycoming)	.35
AN74A-31	Bolt - Bracket Regulator Valve (Lycoming)	.40
AN75A-11	Bolt - Junction Adapter	.40
AN76-11	Bolt - Attaching Propeller (1-1/8")	.45
AN310-3	Nut - Balance Band Bolt	.07
AN310-6	Nut - Counterweight Bolt	.07
AN310-7	Nut - Counterweight Arm Clamp Bolt	.07

## NUMERICAL PARTS LIST

### AEROMATIC PROPELLER MODELS F200 and F200H

#### A-N PARTS

<u>Part No.</u>	<u>Part Name</u>	<u>Unit Price</u>
AN316-1R	Nut - Check Control Cable End	.07
AN364-624	Nut - Lock Low Pitch Stop	.15
AN365-128	Nut - Preload Lock Pin	.12
AN380C-2-2	Pin - Cotter (Balance Band Bolt)	.05
AN380C-3-2	Pin - Cotter (Counterweight Bolt)	.05
AN380C-3-3	Pin - Cotter (Counterweight Arm Bolt)	.05
AN394-19	Pin - Flat Head	.12
AN486-1	Clevis - Control Cable End	1.60
AN500-10-14	Screw - Fillister Head	.12
AN500A10-18	Screw - Junction Adapter (Continental)	.18
AN502-10-4	Screw - Counterweight Arm Safety	.10
AN822-4	Elbow - 90°	.55
AN9317-11	Grommet - Hi-Cruise	.15
AN926-A416	Lock Washer	.05
AN960-10	Washer - Counterweight Arm Safety Screw	.05
AN960-10L	Washer - Counterweight Arm Safety Screw (Thin)	.05
AN960-116	Washer - Preload Lock Pin	.07
AN960-516	Washer - Junction Adapter Bolt	.07
AN960-616	Washer - Counterweight Bolt	.07
AN3066-20	Nut - Climb Stop Lock	.55

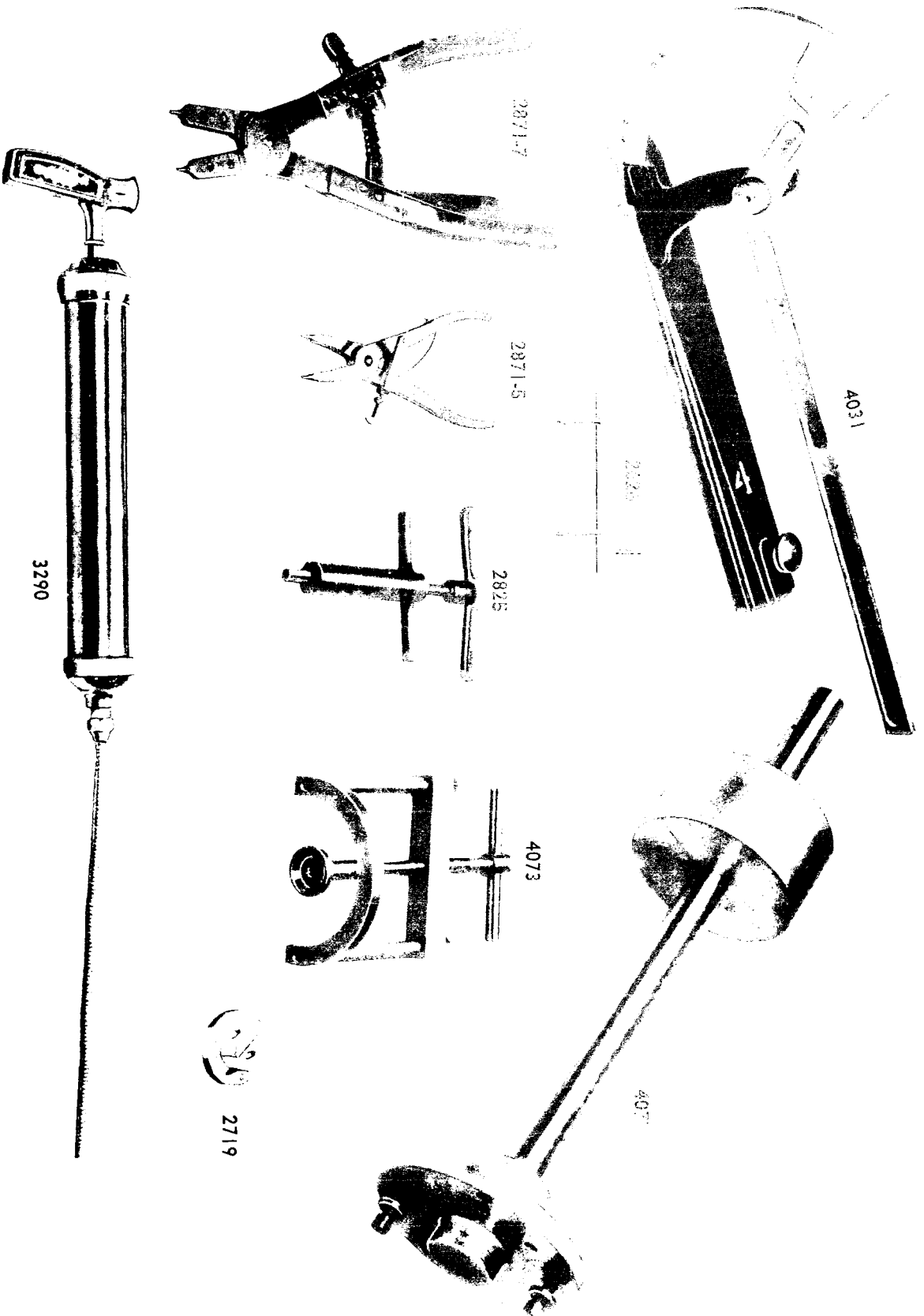

Figure 29. Model F200 Service Tools

S E R V I C E   A N D   O V E R H A U L   T O O L   L I S T

AEROMATIC PROPELLER MODELS F200 and F200H

<u>Part No.</u>	<u>Part Name</u>	<u>Unit Price</u>
2626	Protractor Adapter	16.50
2719	Stop - Fixed Pitch	8.50
2825	Preloading Tool	27.50
2871-5	Pliers - Flange Plate Snap Ring	3.80
2871-7	Pliers - Thrust Bearing Ret. Snap Ring	10.60
2871-7T	Snap Ring Plier Tip	(pair) 3.00
3298	Drill Jig Assembly	17.50
	Consists of:	
3298-1	Drill Jig	
3298-2	Drill Bushing	
3298-3	Tap Bushing	
3298-4	Lock Screw	
3298-5	Locating Screw	
	Std. #23 Drill	
	Std. #10 Tap	
3300	Name Plate Tools	3.90
4031	Universal Protractor	170.45
4077	Balancing Arbor and Adapter	158.20
4073	Name Plate Tool	79.50

**ALPHABETICAL PARTS LIST**  
**AEROMATIC PROPELLER MODELS F200 and F200H**

<u>Part Name</u>	<u>Part Number</u>
Adapter Junction - oil line (Franklin Engine)	20295
Adapter Junction - oil line (Lycoming Engine)	20340
Adapter Junction - oil line (Continental Engine)	20342
Balance Weight Band Assembly	2951
Bearing - Preload	2668
Bearing - Thrust	2704
Bearing - Thrust (To fit No.3288-1 Flange)	2704-1
Bearing Balls	2704-B
Blade Assembly - Model 00-76B	P4981-76
Blade Assembly - Model 00-76BL	P4981-76L
Blade Assembly - Model 00-76BS	P4981-76S
Blade Assembly - Model 00-72C	P4988-72
Blade Assembly - Model 00-73D	P4990-73
Blade Assembly - Model 00-74B	P4999-74
Blade Assembly - Model 00-72D	P40000-72
Blade Assembly - Model 00-68E	P40002-68
Blade Assembly - Model 00-73E	P40002-73
Blade Assembly - Model 00-73EL	P40002-73L
Blade Assembly - Model 00-74E	P40003-74
Blade Assembly-- Model 00-74ES	P40003-74S
Blade Assembly - Model 00-78BL	P40005-78L
Bolt	AN3-4A
Bolt Balance Band	AN3-21
Bolt - Regulator Valve - Mounting	AN4-11A
Bolt - Counterweight (1-1/2")	AN6-14
Bolt - Counterweight (1-5/8")	AN6-15
Bolt - Counterweight (1-3/4")	AN6-16
Bolt - Counterweight (1-7/8")	AN6-17
Bolt - Counterweight (2")	AN6-20
Bolt - Counterweight (2-1/8")	AN6-21
Bolt - Counterweight (2-1/4")	AN6-22
Bolt - Counterweight (2-3/8")	AN6-23
Bolt - Counterweight Arm Clamp	AN7-20

ALPHABETICAL PARTS LIST  
AEROMATIC PROPELLER MODELS F200 and F200H

<u>Part Name</u>	<u>Part Number</u>
Bolt - Junction Adapter	AN74A-11
Bolt Bracket Regulator Valve (Lycoming)	AN74A-25
Bolt - Bracket	AN74A-31
Bolt - Junction Adapter	AN75A-11
Bolt - Attaching - Propeller (1-1 8")	AN76-11
Bracket - Hi-Cruise - Valve Mounting (Franklin)	20352
Bracket - Hi-Cruise - Valve Mounting (Lycoming)	20360
Bracket - Hi-Cruise - Valve Mounting (Continental)	20428
Bracket - Cable Support	10001
Bushing - Preload Cushion	20096
Button - Synchronizer Piston Pin	2959
Cable - Hi-Cruise Control	20291
Cable - Hi-Cruise Control (Stinson)	20291-2
Cable - Hi-Cruise Control (Bellanca)	20291-5
Cable - Hi-Cruise Control (Piper)	20291-8
Clamp - Cable	10002
Clevis - Rod End - Hi-Cruise Control	AN486-1
Cork - Blade Shank Sealing (perC)	2810-21
Counterweight (.25 oz)	2721-1
Counterweight (.5 oz)	2721-2
Counterweight (1.0 oz)	2721-3
Counterweight (2.0 oz)	2721-4
Counterweight (2.5 oz)	2721-9
Counterweight (5.0 oz)	2721-7
Counterweight Arm	3239
Cover - Hi-Cruise Actuating Cylinder	23386
Cover - Synchronizer Cylinder	2879
Cylinder - Actuating Hi-Cruise Control	20383
Elbow - 90°	AN822-4
Flange Blade (LH Rotation - Tractor)	3276-1
Flange Blade (Standard)	3277-1
Flange Blade (LH Rotation - Pusher)	3288A
Flange Blade (Oversize RH Rotation - Pusher)	3288-1
Flange Seal Plate	2185

**ALPHABETICAL PARTS LIST**  
**AEROMATIC PROPELLER MODELS F200 and F200H**

<u>Part Name</u>	<u>Part Number</u>
Gasket - Actuating Cylinder Cover - Hi-Cruise	20399
Gasket - Junction Adapter	20357
Gasket - Junction Adapter (Continental Engine)	20341
Gasket - Junction Adapter (Franklin Engine)	20343
Grommet - Hi-Cruise	AN931-7-11
Hub (only)	4766
Hub (only) Modified for Hi-Cruise	4766H
Instruction Booklet	20029
Kit - Cooling (Stinson 108-2, -3)	1086
Kit - Plastic Repair	20011
Label - Patent	20035
Lacquer - Surface Primer	20147-1
Lacquer - Black	20148-1
Lacquer - Thinner	20149-8
Lead Wool (per lb.)	2290
Link - Synchronizer	20032
Link - Synchronizer (Left Hand)	2910
Link - Synchronizer (Hi-Cruise Control)	20366
Locating Screw - Counterweight Arm (5-16-24)	2894
Lock - Bearing Retainer Snap Ring	20104
Lock - Bearing Retainer Snap Ring - Oversize (Use only on Hubs marked with a letter "G" stamped on the Synchronizer Cylinder Flange Face)	20105-A
Lock Pin - Preload	2198
Lubricant - 5M (1 Pt.)	20239-1
Lubricant - 5M (1 Gal.)	20239-8
Manual - Service Overhaul	20122

ALPHABETICAL PARTS LIST  
AEROMATIC PROPELLER MODELS F200 and F200H

<u>Part Name</u>	<u>Part Number</u>
Name Plate - Hub	2711
Nut - Balance Band Bolt	AN310-3
Nut - Counterweight Arm Clamp Bolt	AN310-7
Nut - Counterweight Bolt	AN310-6
Nut - Preload Lock Pin	AN365-128
Nut - Lock (Hi-Cruise Stop)	AN3066-20
Nut - Check Control Cable End	AN316-4R
Nut - Lock Low Pitch Stop	AN361-624
Nut - Lock Climb Stop	AN3066-20
Oil Line - Flexible (Hi-Cruise)	20406-8
Oil Line - Flexible (Hi-Cruise)	20406-13
Oil Line - Flexible (Hi-Cruise)	20406-14
Oil Line - Flexible (Hi-Cruise)	20408-8
Oil Line - Flexible (Hi-Cruise)	20408-10
Oil Line - Flexible (Hi-Cruise)	20408-11
Oil Line - Flexible (Hi-Cruise)	20408-12
Oil Line - Flexible (Hi-Cruise)	20408-13
Oil Line - Assembly Hub	20268
Packing Flange Seal	20109
Pilot - Bearing Preload	2109
Pin - Cotter (Balance Band Bolt)	AN380-2-2
Pin - Cotter (Counterweight Arm Bolt)	AN380C-3-3
Pin - Cotter (Counterweight Bolt)	AN380C-3-2
Pin - Flat Head (Hi-Cruise)	AN394-17
Pin - Flat Head (Hi-Cruise)	AN394-19
Pin - Name Plate Locking	2961
Pin - Synchronizer Piston	2681
Piston - Synchronizer	2682
Piston - Synchronizer (Hi-Cruise)	20252
Piston - Actuating Hi-Cruise	20385
Plastic - Aeroloid (8 sq. ft. approx.) (S)	2187-40B
Plate - Synchronizer Piston (Hi-Cruise)	20310
Plate - Thrust Bearing Retainer	2918
Plug - Lubricant	2740
Putty - 1 lb. tube	20146-1

ALPHABETICAL PARTS LIST  
AEROMATIC PROPELLER MODELS F200 and F200H

<u>Part Name</u>	<u>Part Number</u>
Regulator - Valve Assembly (std.)	3355
Regulator - Valve Assembly (For Piper Pacer)	3355-1
Rivet - Tipping	2983-6
Rubbing Compound (1 qt. can)	20150-1
Screw - Counterweight Arm Safety	AN502-10-4
Screw - Counterweight Arm Locating	2894
Screw - Counterweight Arm Locating	3298-5
Screw - Synchronizer Cover Plate (1 2")	2832-8
Screw - Synchronizer Cover Plate (5 8")	2832-10
Screw - Synchronizer Cover Plate (3 4")	2832-12
Screw - Tipping (3 8")	2984-3
Screw - Tipping (1 2")	2984-4
Screw - Low Pitch Stop (Hi-Cruise)	20259
Screw - Fillister Head	AN500-10-14
Screw - Junction Adapter	AN500A10-18
Seal - Flange Plate	2914
Seal - Synchronizer Cover Plate	2819
Seal - Thrust Bearing	2705
Seal - Flange (Hi-Cruise)	20263
Seal - Engine Flange (Hi-Cruise)	20265
Seal - "O" Ring (1-1 16" O.D. Hi-Cruise)	20272
Seal - "O" Ring (3" O.D. Hi-Cruise)	20274
Shim - Flange Seal Packing - Flared (std.)	20101
Shim - Flange Seal Packing - Outer	20036
Shim - Flange Seal Packing - Inner	2993-5
Shim - Flange Seal Packing - Inner	2993-16
Shim - Low Pitch Adjustment	2674-16
Shim - Low Pitch Adjustment	2674-62
Shim - Flange Seal Packing - Inner (Used with Flange No. 3288-1)	20097-5
Shim - Flange Seal Packing - Inner (Used with Flange No. 3288-1)	20097-16
Shim - Flange Seal Packing - Outer (Used with Flange No. 3288-1)	20098
Shim - Flange Seal Packing - Flared (Used with Flange No. 3288-1)	20099
Sleeve - Bearing Preload	2195
Sleeve - Bearing Preload Cushion	2195B
Snap Ring - Counterweight Arm	2712

ALPHABETICAL PARTS LIST  
AEROMATIC PROPELLER MODELS F200 and F200H

<u>Part Name</u>	<u>Part Number</u>
Snap Ring - Flange Plate	2191
Snap Ring - Thrust Bearing Retainer	2667
Spacer - Low Pitch Stop (.092")	20003-1
Spacer - Low Pitch Stop (.125")	20003-2
Spinner Post (Bellanca)	20119
Spring - Balance Weight	2706
Spring - Flange Seal Packing	2995-1
Spring - Actuating Cylinder (Hi-Cruise)	20384
Stop - Climb Low Pitch (Hi-Cruise)	20316
Tipping Cap (Standard)	2987-S
Tipping Cap (Seaplane and Service Replacement)	4357
Tipping Leading Edge	2967
Transfer - Aeromatic Trade Mark	2170
Transfer - Check Lubricant (25 hrs.)	2428-25
Transfer - Univair Trade Mark	20078
Transfer - Push to increase RPM (Hi-Cruise)	20125
Transfer - Snap Ring Opening	20145
Transfer - Cement	20I52-1
Transfer - Detergent	20153-1
Washer - Attaching Bolt	2506
Washer - Counterweight Arm Locating Screw	2714-3
Washer - Counterweight Arm Safety Screw	AN960-10
Washer - Counterweight Arm Safety Screw (Thin)	AN960-10L
Washer - Preload Lock Pin	AN960-416
Washer - Balance	2876
Washer	AN960-8
Washer - Junction Adapter Bolt	AN960-516
Washer - Counterweight Bolt	AN960-616
Washer - Lock	AN936-A416
Washer - Copper (Hi-Cruise)	2934-3

# EXPLODED VIEW INDEX

## MODEL F200 HUB

<u>Part Number</u>	<u>Part Name</u>
20366 or (2910) or (20032)	Synchronizer Link
2681	Synchronizer Piston Pin
2959	Synchronizer Piston Pin Ring
2682 or (20252)	Synchronizer Piston
20003-1	Low Pitch Adjustment Spacer
20003-2	Low Pitch Adjustment Spacer
2819	Synchronizer Cover Plate Seal
2674-16 or (2674-62)	Low Pitch Adjustment Shim
2879	Synchronizer Cover Plate
2832-8	Synchronizer Cover Plate Screw
2832-10	Synchronizer Cover Plate Screw
2740	Plug Lubricant
2195 or (2195B)	Bearing Preload Sleeve
2199	Bearing Preload Pilot
2668	Preload Bearing
2198	Preload Lock Pin
AN960-416	Preload Lock Pin Washer
AN365-428	Preload Lock Pin Nut
3277 or (3277-1)	Flange (Blade)
2914	Flange Plate Seal
2185	Flange Plate
2191	Flange Plate Snap Ring
2994	Flange Seal Packing
2995-1	Flange Seal Packing Spring
2993-5	Flange Seal Packing Shim (Inner)
20101	Flange Seal Packing Shim (Flared)
20036	Flange Seal Packing Shim (Outer)
2704	Thrust Bearing
2705	Thrust Bearing Retainer Seals
2918	Thrust Bearing Retainer Plate
2667	Thrust Bearing Retainer Snap Ring
3239	Counterweight Arm
2712	Counterweight Arm Snap Ring
AN7-20	Counterweight Arm Clamp Bolt
AN310-7	Counterweight Arm Clamp Nut
2721-1	Counterweight
2721-2	Counterweight
2721-3	Counterweight
2721-4	Counterweight
2721-7	Counterweight
2721-9	Counterweight
2894 or (3298-5)	Counterweight Arm Locating Screw
AN502-10-4	Counterweight Arm Safety Screw
2714-3	Counterweight Arm Locating Screw Washer



# EXPLODED VIEW INDEX

## MODEL F200 HUB

<u>Part Number</u>	<u>Part Name</u>
AN6-16-17-20	Counterweight Bolt
AN310-6	Counterweight Bolt Nut
AN502-10-4	Counterweight Arm Safety Screw
2951	Balance weight Band
2876	Balance Weight
2706	Balance Weight Spring
AN3-22	Balance Weight Bolt
AN310-3	Balance Weight Nut
AN76-10 or ( AN76-11)	Attaching Bolt
2506	Attaching Bolt Washer
20029	Field Service Instructions
4766 or ( 4766H)	Hub ( Only )

INDEX EXPLODED VIEW

AEROMATIC HI-CRUISE CONTROL ASSEMBLY MODEL F200H

<u>Index No.</u>	<u>Part No.</u>	<u>Part Name</u>	<u>Unit Per Assy.</u>
1	20378	Elbow - 45 <sup>0</sup> Inverted	2
2	2740	Plug - Lubricant	1
3	20270	Nut - Inverted	2
4	20252	Piston - Synchronizer	1
5	4766H	Hub - Hi-Cruise Control	1
6	20383	Cylinder - Hi-Cruise Control	1
7	20268-1	Aluminum Alloy Tubing - 5/16 O.D.	1
8	2740	Plug - Bleed	1
9	2832-12	Screw - Cylinder	6
10	2934-3	Copper Washer - Cylinder Screw	6
11	2819	Seal - Cylinder	1
12	20399	Gasket - Cylinder Cover	1
13	20384	Spring - Actuating Piston	1
14	20385	Piston - Actuating Cylinder	1
15	AN364-624	Lock Nut - 3/8 - 24 NF	1
16	20310	Plate - Synchronizer Piston	1
17	20274	Seal - "O" Ring - Outer	1
18	20272	Seal - "O" Ring - Inner	1
19	20386	Cover - Cylinder	1
20	AN364-624	Lock Nut - 3/8 - 24 NF	1
21	20259	Screw - Aeromatic Low Pitch Stop	1
22	AN3066-20	Nut - Hi-Cruise Low Pitch Stop	1
23	20316	Stop - Hi-Cruise Low Pitch	1
24	2832-8	Screw - Cover	8
25	AN960-10	Washer - Cover Screw	8
26	AN394-19	Pin - Control Cable Clevis	1
27	AN960-416	Washer - Cable Clevis Pin	1
28	AN380C-2-2	Cotter Pin	1
29	AN316-4R	Check Nut - Control Cable End	1
30	AN486-1	Clevis - Control Cable End	1
31	3355-1	Regulator Valve Assembly	1
32	20291	Control Cable	1

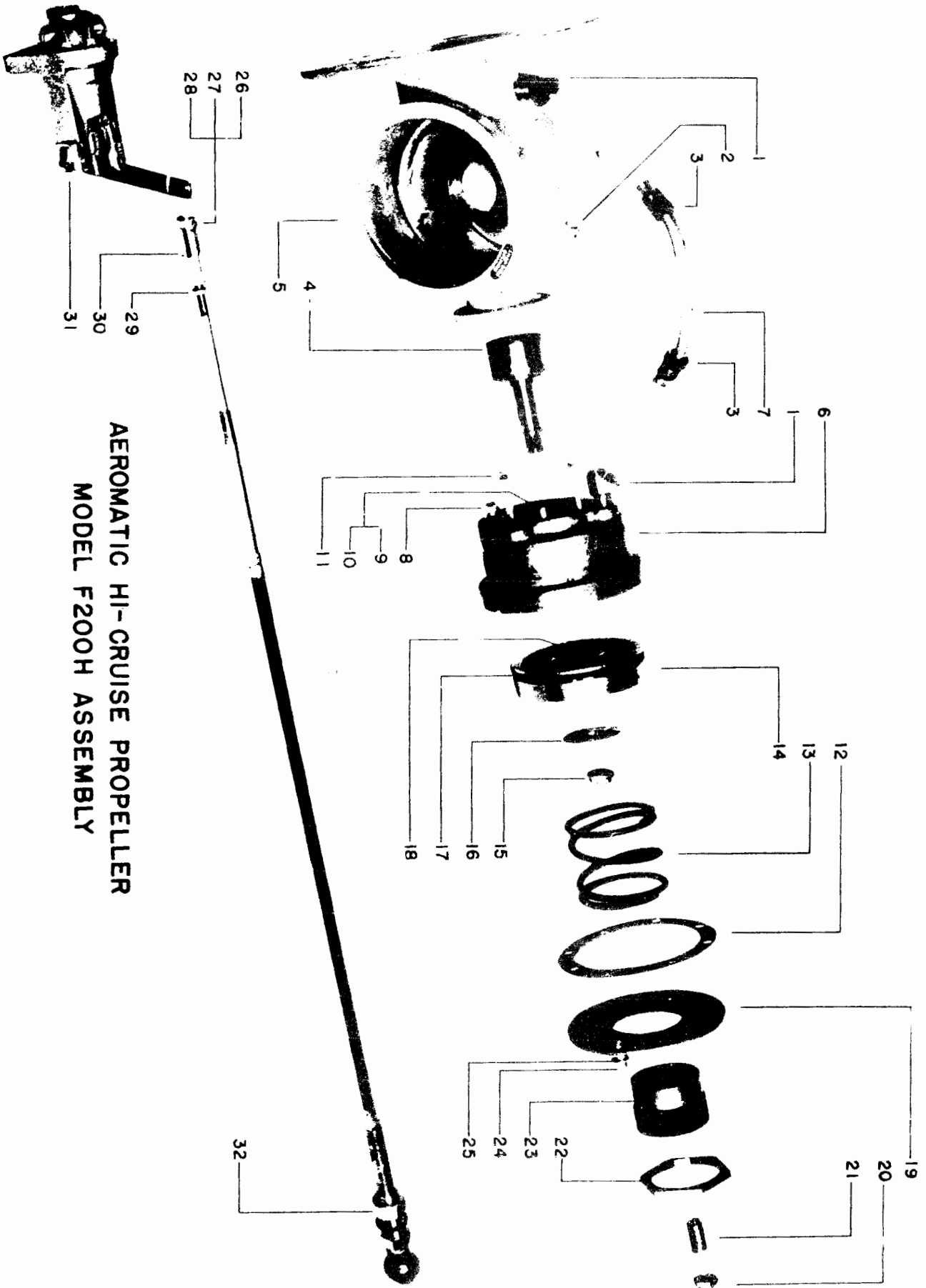

AEROMATIC HI-CRUISE PROPELLER  
MODEL F200H ASSEMBLY